

# CARTON SUITE

The Carton Suite is a contemporary meeting space that seamlessly reflects the grandeur of the estate. It has been designed with fluidity of purpose in mind. This very special space combines new thinking and design with a refined and luxurious aesthetic.

The suite can be divided into three for smaller gatherings, or used as one large, open and inclusive space. Large international conferences, exhibitions, car launches, training events, sports teams gatherings - the Carton Suite has experienced it all and more.

Enjoy ample natural light and refreshing breaks out on the manicured lawn. Later, the Carton Suite can become a sophisticated venue for a gala dinner or a shimmering ballroom for up to 330 dinner guests.

Room	Sq mts	Ceiling Height	Banquet	Theatre	Classroom	Boardroom	U-shape	Dinner Dance	Cabaret
Carton Suite	510	3.2m	360	400	250	-	94	330	250
Carton Suite1	162	3.2m	100	150	60	40	42	100	60
Carton Suite2	186	3.2m	100	150	60	40	42	100	60
Carton Suite3	162	3.2m	100	150	60	40	42	100	60
Pre-function Foyer	190	2.5m	-	-	-	-	-	-	-

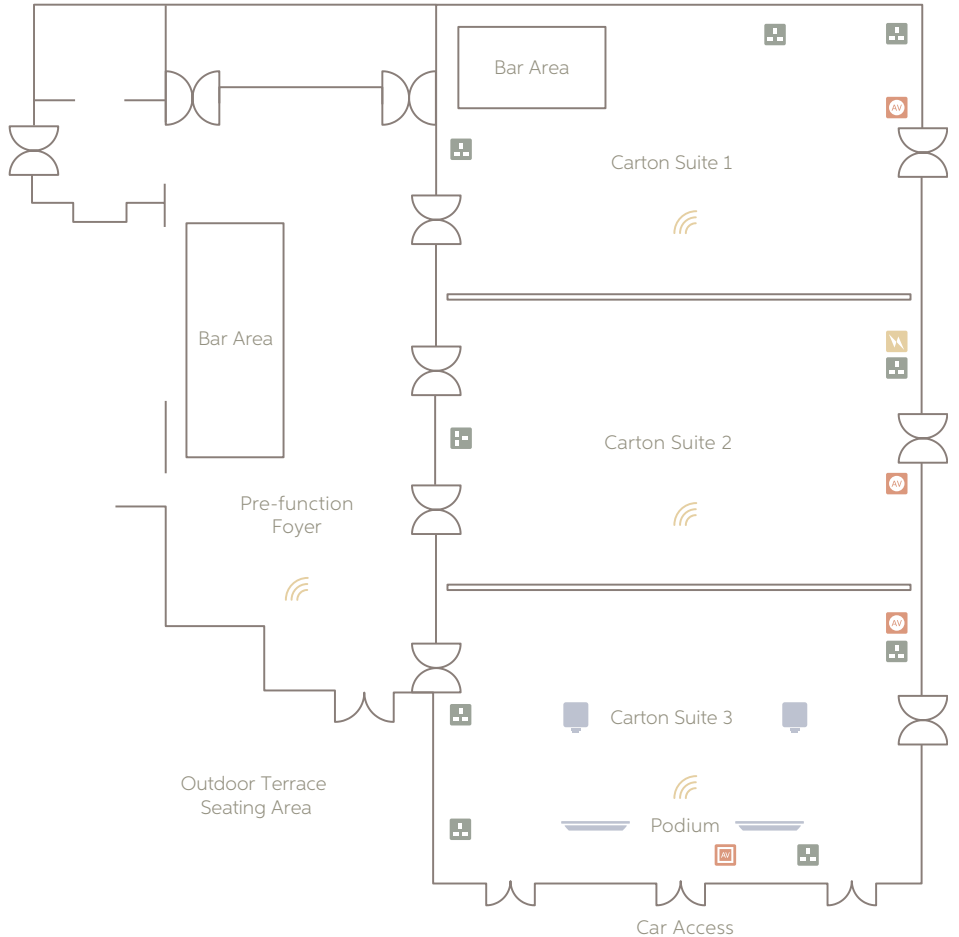

# FITZGERALD SUITE

A brand new addition to Carton House, these modern, bright, state of the art spaces are versatile and elegant. The Miss Sandford is ideal for smaller gatherings up to 12 guests while the Lady Granville and Princess Grace can hold up to 80 guests. The Lady Granville can also be divided into 2 smaller spaces.

Each space has a private breakout area with check in desk, outdoor terrace and magnificent views of the estate vistas.

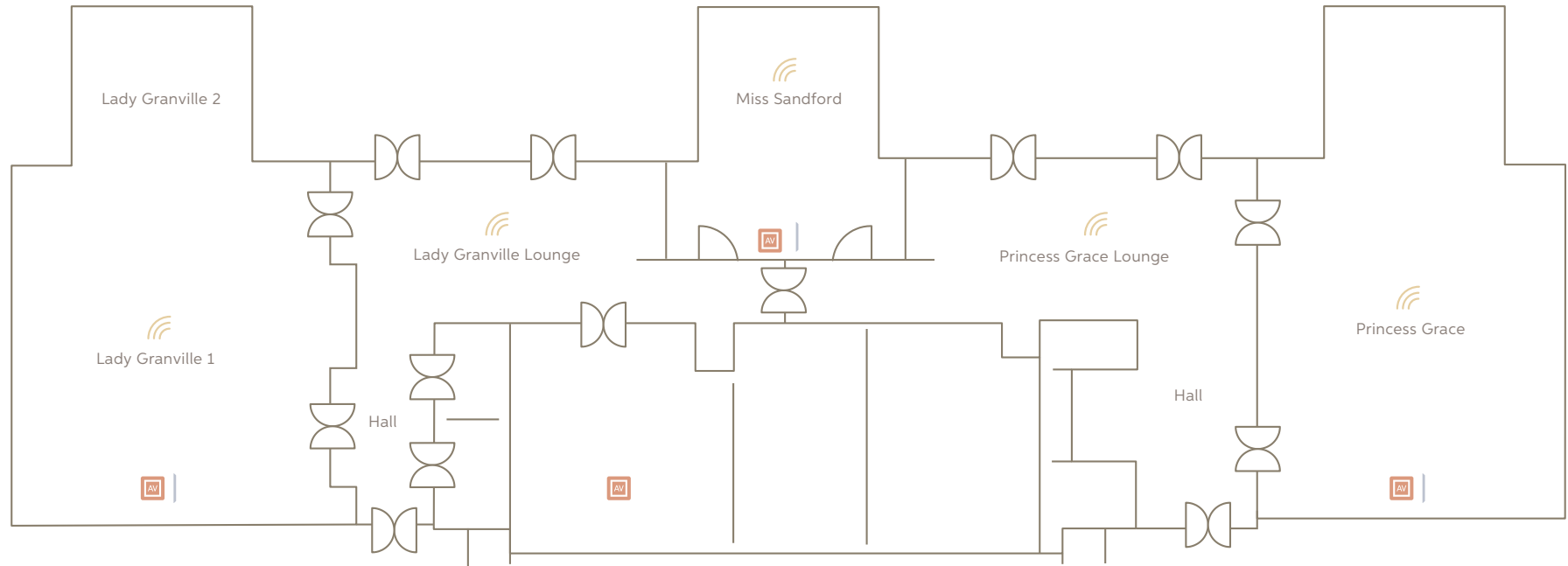

Room	Sq mts	Ceiling Height A	Ceiling Height B	Theatre	Classroom	Boardroom	U-Shape	Cabaret	Dinner
Lady Granville	102	4.2	2.9	80	40	28	28	42	50
Miss Sandford	37	4.2	2.85	-	-	10	-	-	-
Princess Grace	98	4.2	2.9	80	40	28	28	42	50

-  AV Socket
-  AV Equipment
-  Screen
-  Power Point
-  WiFi Enabled
-  Ceiling Projector
-  Car Access & Loading - 4000kg

# LEINSTER BOARDROOM AND KILDARE SUITE

The Leinster Boardroom or the Kildare Suite at Carton House are the perfect choice for more intimate meetings. Similar to the Fitzgerald Suite on the floor located below, the Kildare Suite can be divided into three smaller meeting rooms also.

Our boardroom and suites are ideal for business planning and team-building workshops. Orangeworks our on-site experience partners, also offer an exciting range of engaging team-building activities and experiences for you and your team to enjoy on the resort, inside or out. Contact us for more information regarding this.

Room	Sq mts	Ceiling Height	Theatre	Classroom	Boardroom	U-shape	Cabaret
Leinster Boardroom	34	2.4m	-	-	14	-	-
Kildare Suite	288	2.4m	100	60	40	40	54
Kildare Suite 1	102	2.4m	30	20	18	18	-
Kildare Suite 2	86	2.4m	30	20	18	18	-
Kildare Suite 3	99	2.4m	30	20	18	18	-

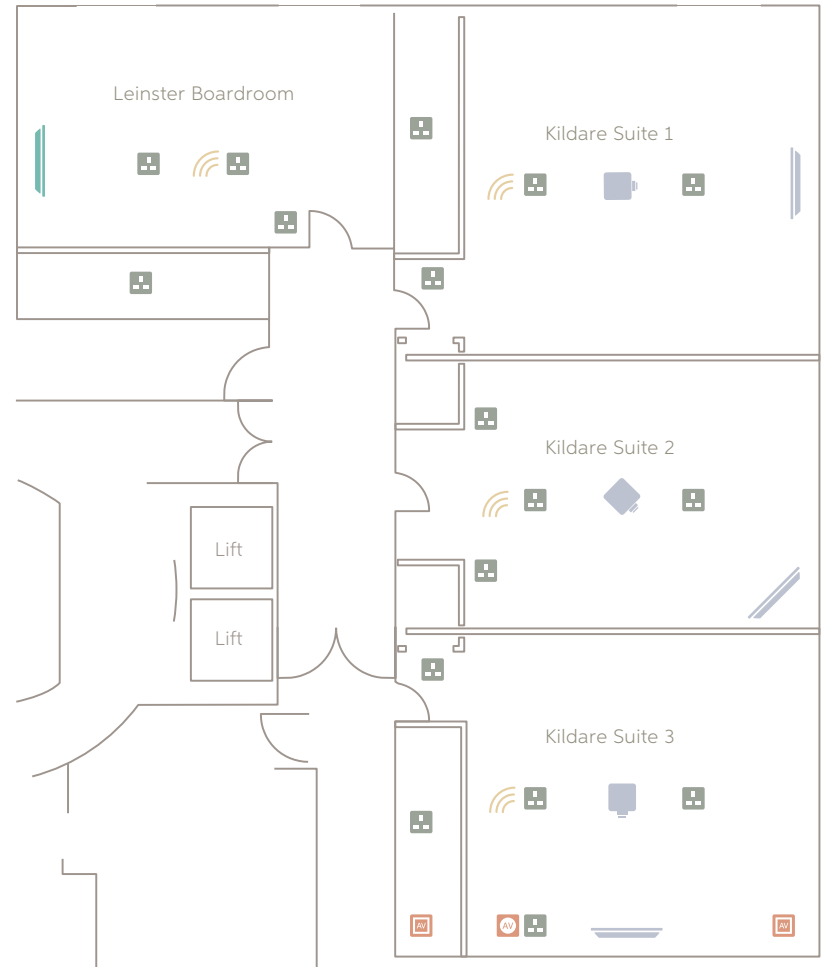

# THE HOUSE MAP

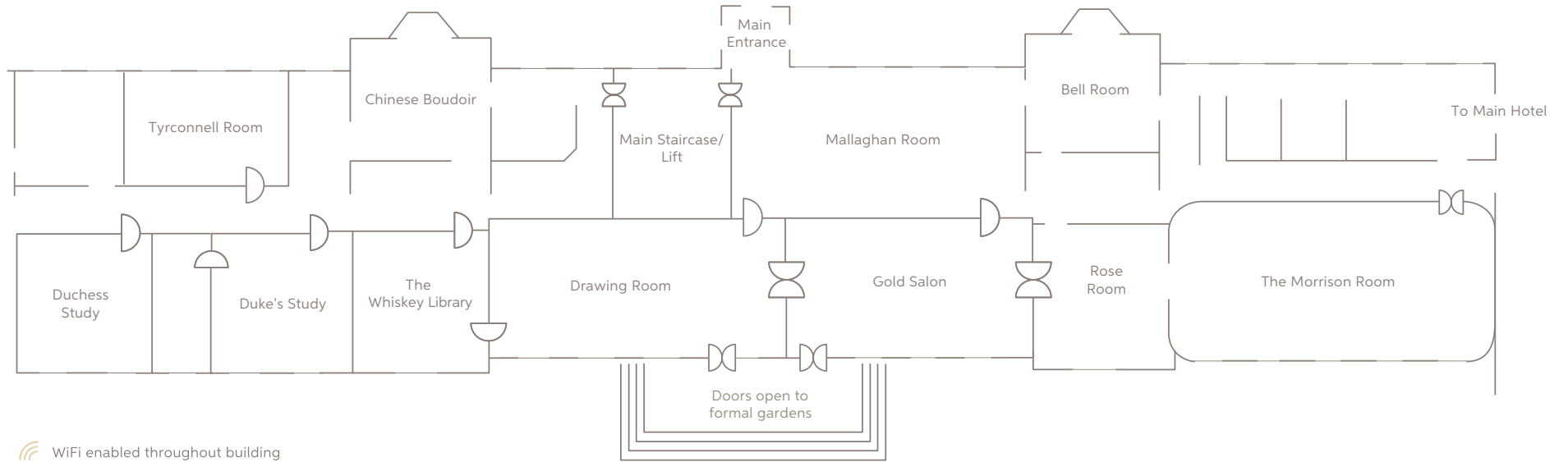

WiFi enabled throughout building

Room	Sq mts	Boardroom	Private Dining
Dukes Study	31	10	10
The Drawing Room	84	-	45
The Tyrconnell	37.5	14	14
The Morrison Room	116	-	-
The Rose Room	35	-	-
The Gold Salon	65	-	30